

LEGENDA

- Y11** **razvijanje** **1. faza**
- Y12** **razvijanje** **2. faza**
- Y13** **razvijanje** **3. faza**
- Y14** **razvijanje** **4. faza**
- Y15** **razvijanje** **5. faza**
- Y16** **razvijanje** **6. faza**
- Y17** **razvijanje** **7. faza**
- Y18** **razvijanje** **8. faza**
- Y19** **razvijanje** **9. faza**
- Y20** **razvijanje** **10. faza**
- Y21** **razvijanje** **11. faza**
- Y22** **razvijanje** **12. faza**
- Y23** **razvijanje** **13. faza**
- Y24** **razvijanje** **14. faza**
- Y25** **razvijanje** **15. faza**
- Y26** **razvijanje** **16. faza**
- Y27** **razvijanje** **17. faza**
- Y28** **razvijanje** **18. faza**
- Y29** **razvijanje** **19. faza**
- Y30** **razvijanje** **20. faza**
- Y31** **razvijanje** **21. faza**
- Y32** **razvijanje** **22. faza**
- Y33** **razvijanje** **23. faza**
- Y34** **razvijanje** **24. faza**
- Y35** **razvijanje** **25. faza**
- Y36** **razvijanje** **26. faza**
- Y37** **razvijanje** **27. faza**
- Y38** **razvijanje** **28. faza**
- Y39** **razvijanje** **29. faza**
- Y40** **razvijanje** **30. faza**

1:0

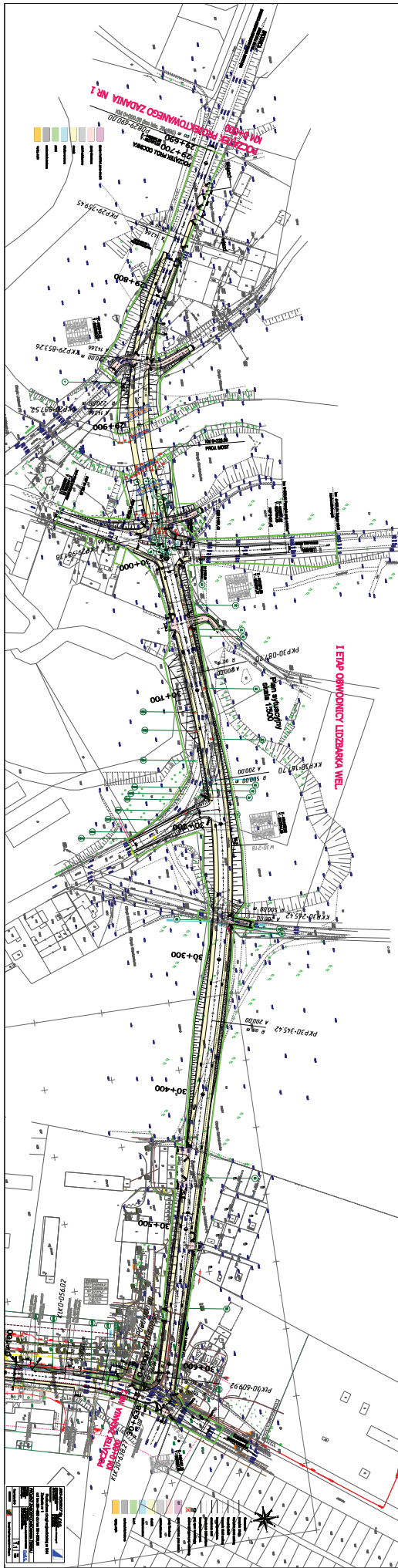

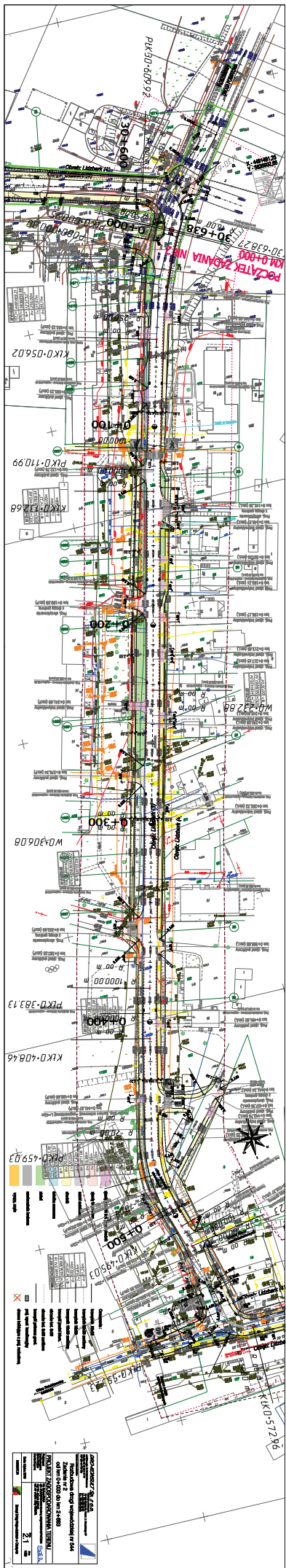

PROJEKTOVÝ ÚSTUP Územný plán obce	
Miesto:	Územný plán obce
Dátum:	2024
Mierka:	1:500
Autor:	[Name]
Schválil:	[Name]
Dátum schválenia:	2024
Číslo:	[Number]
Stav:	[Status]

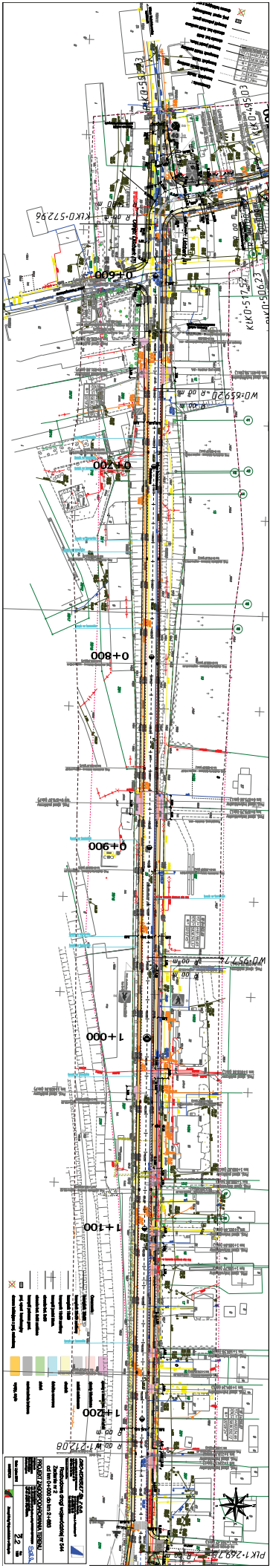

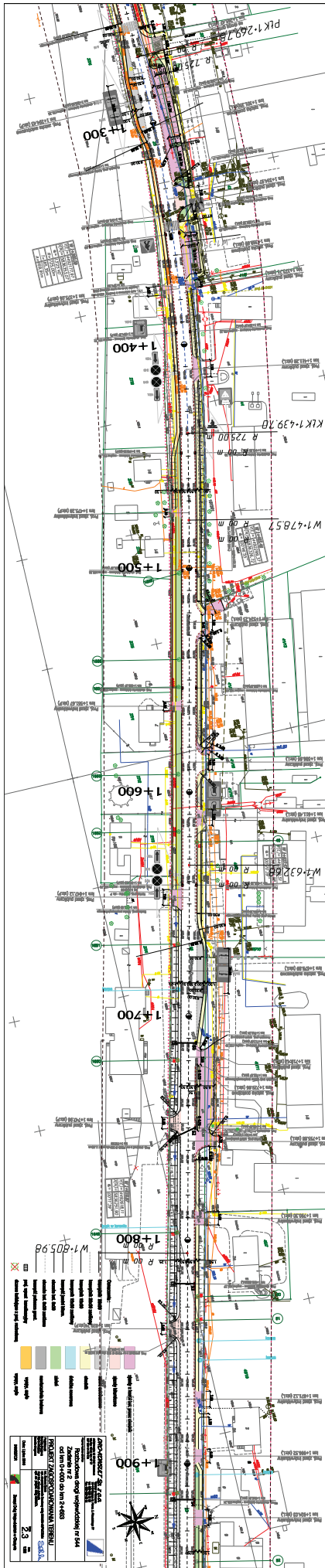

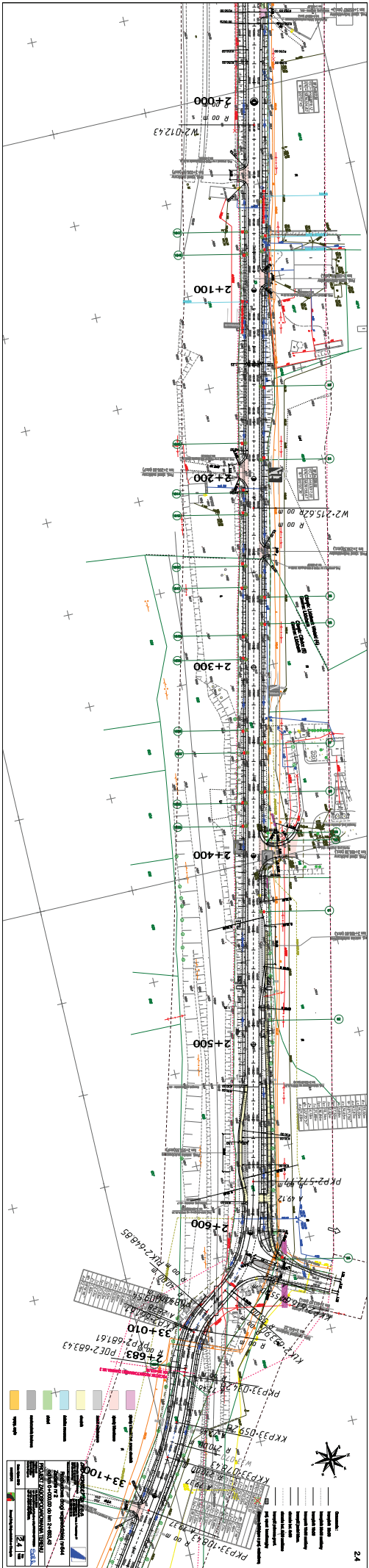

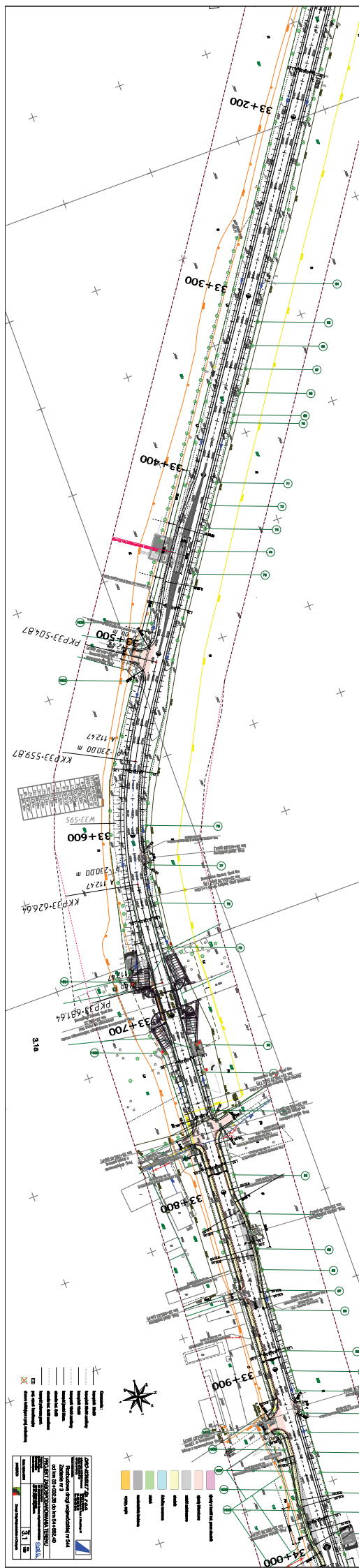

PK	Station	Notes
PKP33-504.87	33+500	Point of Beginning (P.B.)
KK P33-559.87	33+600	Point of Curvature (P.C.)
PK P33-626.66	33+700	Point of Tangency (P.T.)
PK P33-681.64	33+800	Point of Beginning (P.B.)

PK	Station	Notes
PKP33-504.87	33+500	Point of Beginning (P.B.)
KK P33-559.87	33+600	Point of Curvature (P.C.)
PK P33-626.66	33+700	Point of Tangency (P.T.)
PK P33-681.64	33+800	Point of Beginning (P.B.)

PK	Station	Notes
PKP33-504.87	33+500	Point of Beginning (P.B.)
KK P33-559.87	33+600	Point of Curvature (P.C.)
PK P33-626.66	33+700	Point of Tangency (P.T.)
PK P33-681.64	33+800	Point of Beginning (P.B.)

PK	Station	Notes
PKP33-504.87	33+500	Point of Beginning (P.B.)
KK P33-559.87	33+600	Point of Curvature (P.C.)
PK P33-626.66	33+700	Point of Tangency (P.T.)
PK P33-681.64	33+800	Point of Beginning (P.B.)

PK	Station	Notes
PKP33-504.87	33+500	Point of Beginning (P.B.)
KK P33-559.87	33+600	Point of Curvature (P.C.)
PK P33-626.66	33+700	Point of Tangency (P.T.)
PK P33-681.64	33+800	Point of Beginning (P.B.)

PK	Station	Notes
PKP33-504.87	33+500	Point of Beginning (P.B.)
KK P33-559.87	33+600	Point of Curvature (P.C.)
PK P33-626.66	33+700	Point of Tangency (P.T.)
PK P33-681.64	33+800	Point of Beginning (P.B.)

PK	Station	Notes
PKP33-504.87	33+500	Point of Beginning (P.B.)
KK P33-559.87	33+600	Point of Curvature (P.C.)
PK P33-626.66	33+700	Point of Tangency (P.T.)
PK P33-681.64	33+800	Point of Beginning (P.B.)

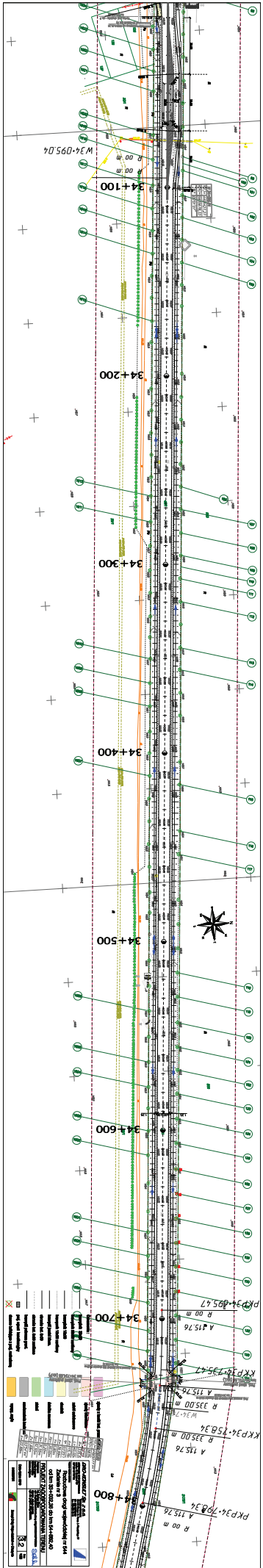

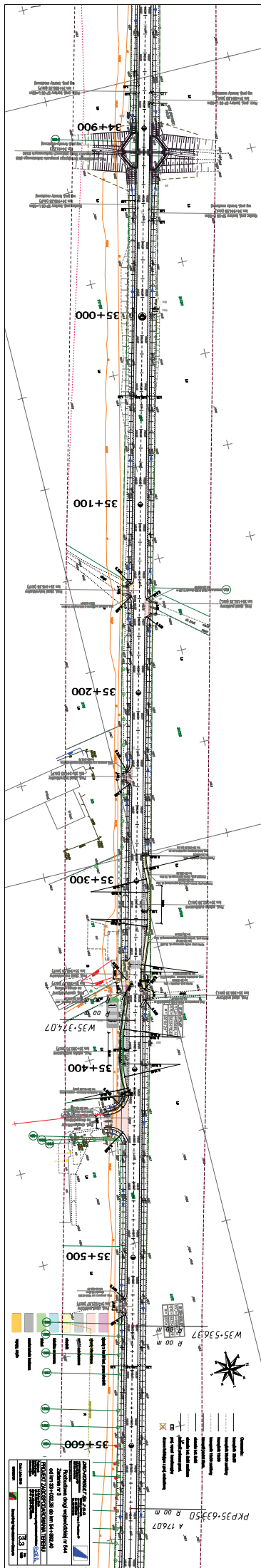

Legende

[Symbol]	Trasse
[Symbol]	Spurweite
[Symbol]	Streckennummer
[Symbol]	Streckenname
[Symbol]	Streckenlänge
[Symbol]	Streckenbreite
[Symbol]	Streckenart
[Symbol]	Streckenklasse
[Symbol]	Streckenstatus
[Symbol]	Streckenbeschreibung

Technische Angaben

Projekt: PKP5-63350
Blatt: A 17607
Skala: 1:500
Datum: 2023-10-27
Autor: [Name]
Geprüft: [Name]

PKP5-63350 R 00 m
A 17607

M35-5367 P 00 m

M35-3747

35+600

35+500

35+400

35+300

35+200

35+100

35+000

34+900